



The play components identified on this plan are IPEMA certified. (Unless model number is preceded with #) The use and layout of these components conform to the requirements of ASTM F1487. To verify product certification, visit [www.ipema.org](http://www.ipema.org)

THIS LAYOUT INCLUDES FITNESS EQUIPMENT FOR USERS AGES 13 AND OLDER. FITNESS EQUIPMENT THAT IS DESIGNED FOR AGES 13 AND OLDER DOES NOT FALL UNDER THE SCOPE OF ASTM F1487 - THE STANDARD CONSUMER SAFETY PERFORMANCE SPECIFICATION FOR PLAYGROUND EQUIPMENT FOR PUBLIC USE. AGE APPROPRIATE SIGNAGE IS RECOMMENDED.

THIS PLAY AREA & PLAY EQUIPMENT IS DESIGNED FOR AGES 5-12 YEARS UNLESS OTHERWISE NOTED ON PLAN.

IT IS THE MANUFACTURERS OPINION THAT THIS PLAY AREA DOES CONFORM TO THE A.D.A. ACCESSIBILITY STANDARDS, ASSUMING AN ACCESSIBLE PROTECTIVE SURFACING IS PROVIDED, AS INDICATED, OR WITHIN THE ENTIRE USE ZONE.

THIS CONCEPTUAL PLAN WAS BASED ON INFORMATION AVAILABLE TO US. PRIOR TO CONSTRUCTION, DETAILED SITE INFORMATION INCLUDING SITE DIMENSIONS, TOPOGRAPHY, EXISTING UTILITIES, SOIL CONDITIONS, AND DRAINAGE SOLUTIONS SHOULD BE OBTAINED, EVALUATED, & UTILIZED IN THE FINAL DESIGN. PLEASE VERIFY ALL DIMENSIONS OF PLAY AREA, SIZE, ORIENTATION, AND LOCATION OF ALL EXISTING UTILITIES, EQUIPMENT, AND SITE FURNISHINGS PRIOR TO ORDERING. SLIDES SHOULD NOT FACE THE HOT AFTERNOON SUN.

CHOOSE A PROTECTIVE SURFACING MATERIAL THAT HAS A CRITICAL HEIGHT VALUE TO MEET THE MAXIMUM FALL HEIGHT FOR THE EQUIPMENT (REF. ASTM F1487 STANDARD CONSUMER SAFETY PERFORMANCE SPECIFICATION FOR PLAYGROUND EQUIPMENT FOR PUBLIC USE, SECTION 8 CURRENT REVISION). THE SUBSURFACE MUST BE WELL DRAINED. IF THE SOIL DOES NOT DRAIN NATURALLY IT MUST BE TILED OR SLOPED 1/8" TO 1/4" PER FOOT TO A STORM SEWER OR A "FRENCH DRAIN".

AREA OF ACCESSIBLE/PROTECTIVE SURFACING (POURED-IN-PLACE SUGGESTED)

DESIGNED BY:

COPYRIGHT: 2013  
LANDSCAPE STRUCTURES, INC.  
601 7th STREET SOUTH - P.O. BOX 198  
DELANO, MINNESOTA 55328  
PH: 1-800-328-0035 FAX: 1-763-972-6091

Date Previous Drawing # Initials

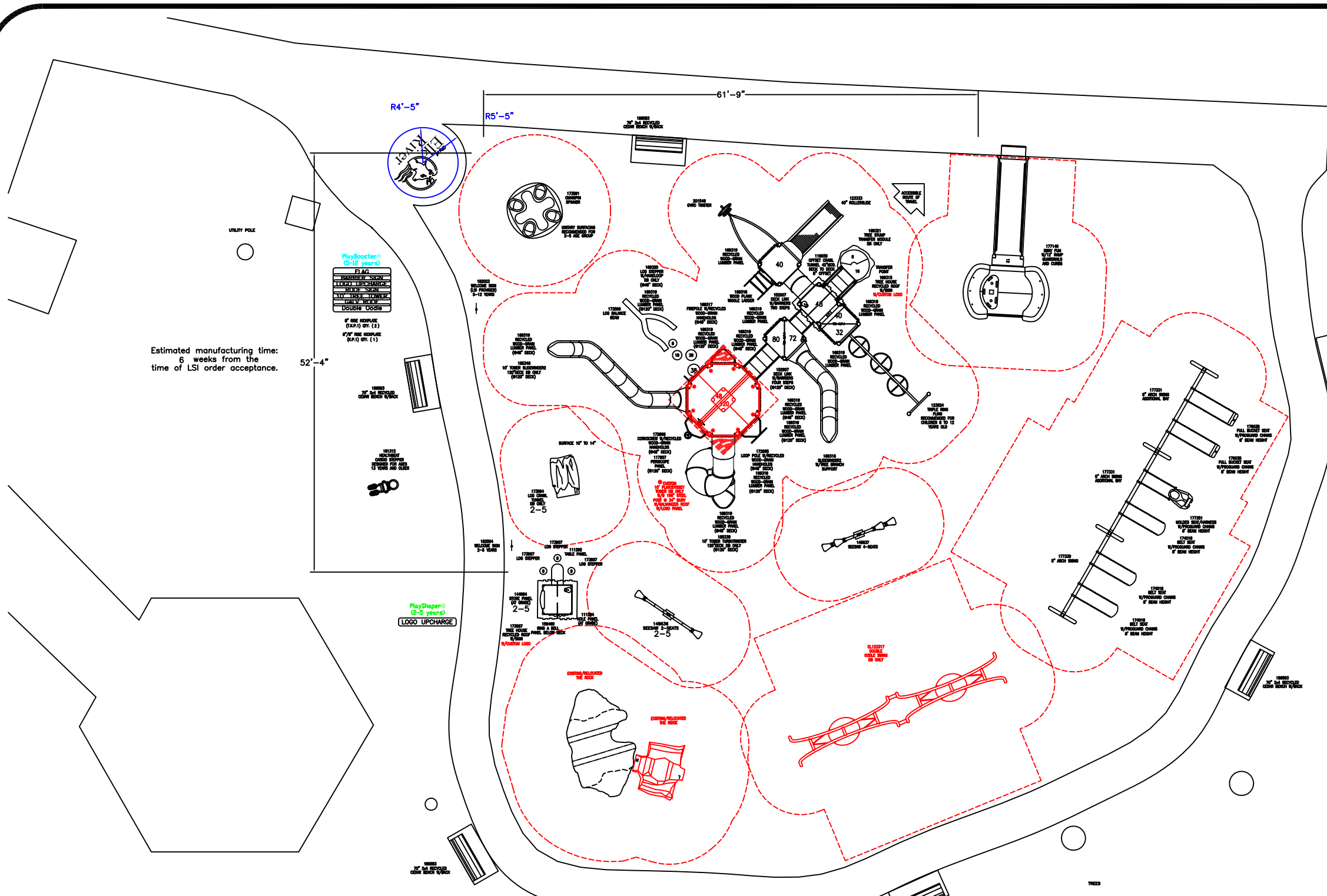

Estimated manufacturing time: 6 weeks from the time of LSI order acceptance.

PlayBooster® (5-12 years)

PLAYBOOSTER - 30" H
TRUCKS - 30" H
TRUCKS - 48" H
TRUCKS - 60" H
TRUCKS - 72" H
TRUCKS - 84" H
TRUCKS - 96" H
TRUCKS - 108" H
TRUCKS - 120" H
TRUCKS - 132" H
TRUCKS - 144" H
TRUCKS - 156" H
TRUCKS - 168" H
TRUCKS - 180" H
TRUCKS - 192" H
TRUCKS - 204" H
TRUCKS - 216" H
TRUCKS - 228" H
TRUCKS - 240" H
TRUCKS - 252" H
TRUCKS - 264" H
TRUCKS - 276" H
TRUCKS - 288" H
TRUCKS - 300" H

PlayShaper® (2-5 years)  
LOGO UPCHARGE

2-5 THE MAXIMUM FALL HEIGHT OF THIS STRUCTURE IS 37"

TOTAL ELEVATED PLAY COMPONENTS	0	REQUIRED	0
TOTAL ELEVATED COMPONENTS ACCESSIBLE BY RAMP	0	REQUIRED	0
TOTAL ELEVATED COMPONENTS ACCESSIBLE BY TRANSFER	0	REQUIRED	0
TOTAL ACCESSIBLE GROUND LEVEL COMPONENTS SHOWN	6	REQUIRED	0
TOTAL DIFFERENT TYPES OF GROUND LEVEL COMPONENTS	6	REQUIRED	6

5-12 THE MAXIMUM FALL HEIGHT OF THIS STRUCTURE IS 120"

TOTAL ELEVATED PLAY COMPONENTS	13	REQUIRED	0
TOTAL ELEVATED COMPONENTS ACCESSIBLE BY RAMP	0	REQUIRED	0
TOTAL ELEVATED COMPONENTS ACCESSIBLE BY TRANSFER	8	REQUIRED	7
TOTAL ACCESSIBLE GROUND LEVEL COMPONENTS SHOWN	15	REQUIRED	4
TOTAL DIFFERENT TYPES OF GROUND LEVEL COMPONENTS	8	REQUIRED	8

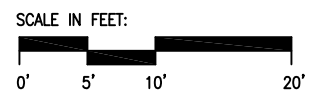

Orono Park  
Elk River, MN

SYSTEM TYPE:  
PlayBooster  
DRAWING #:  
62230-1-5

